



Diese PDF ist ein Teilbereich des neuen SIMTEK Gesamtkatalogs R15 der insgesamt 672 Seiten umfasst. Unter folgendem Link können Sie diesen Gesamtkatalog herunterladen.

This PDF is part of the new SIMTEK main catalog R15 with 672 pages. The following link leads to complete the main catalog.



Hier geht es zum Download
Click here for the download



Das Werkzeugsystem im Überblick The Tool System Overview

Zweischneidig in Bohrungen ab $\varnothing 24,5$ mm.
Two cutting edges in bores as of $\varnothing 24,5$ mm.

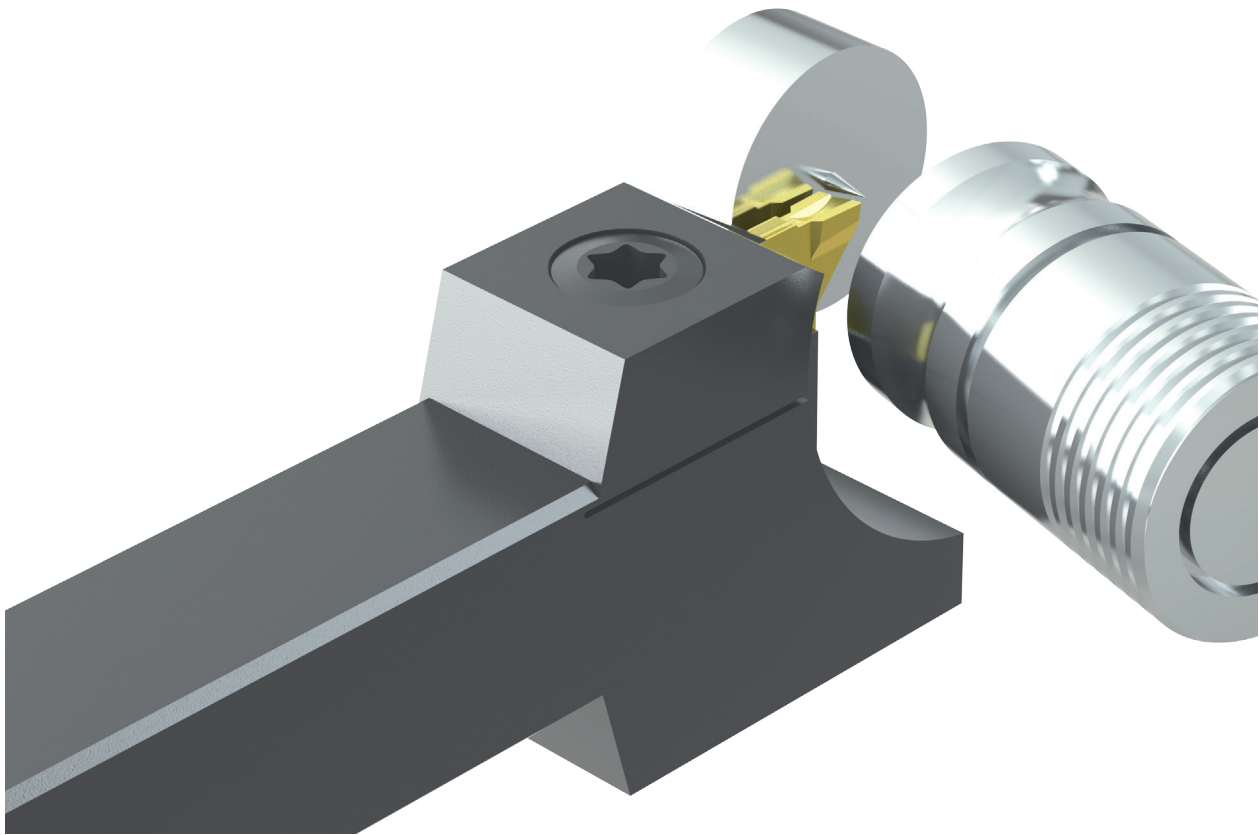

Werkzeugsystem bestehend aus zweischneidigen Hartmetall-Schneidplatten und Stahlträgerwerkzeug. Einsetzbar in Bohrungen ab $\varnothing 24,5$ mm.

Das Schneidwerkzeug, und in speziellem Maße die Schneide, ist auf optimale Spankontrolle und Leistung ausgelegt.

Das spezielle Design des Plattensitzes begünstigt eine optimale Kraftaufnahme und Stabilität.

Tool system of double-edged Carbide insert and steel Toolholder. For use in bores as of $\varnothing 24,5$ mm.

The Cutting insert and especially the cutting edge, was designed to offer best chip control and improved performance in bores.

The special insert seat design enhances the overall stability and cutting force absorption and leads to improved results.

Das System im Detail The System Details

Bitte beachten Sie die allgemeinen Gebrauchshinweise auf Seite
Please read the General Instructions for use on Page

381

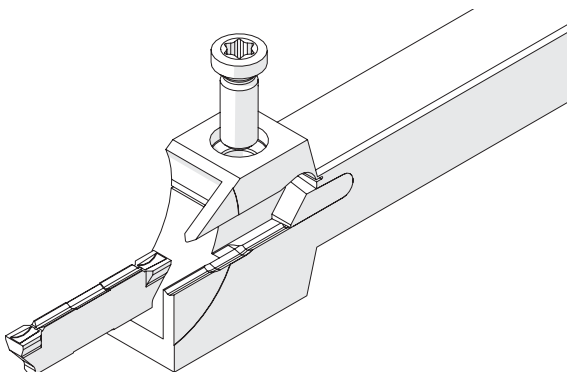
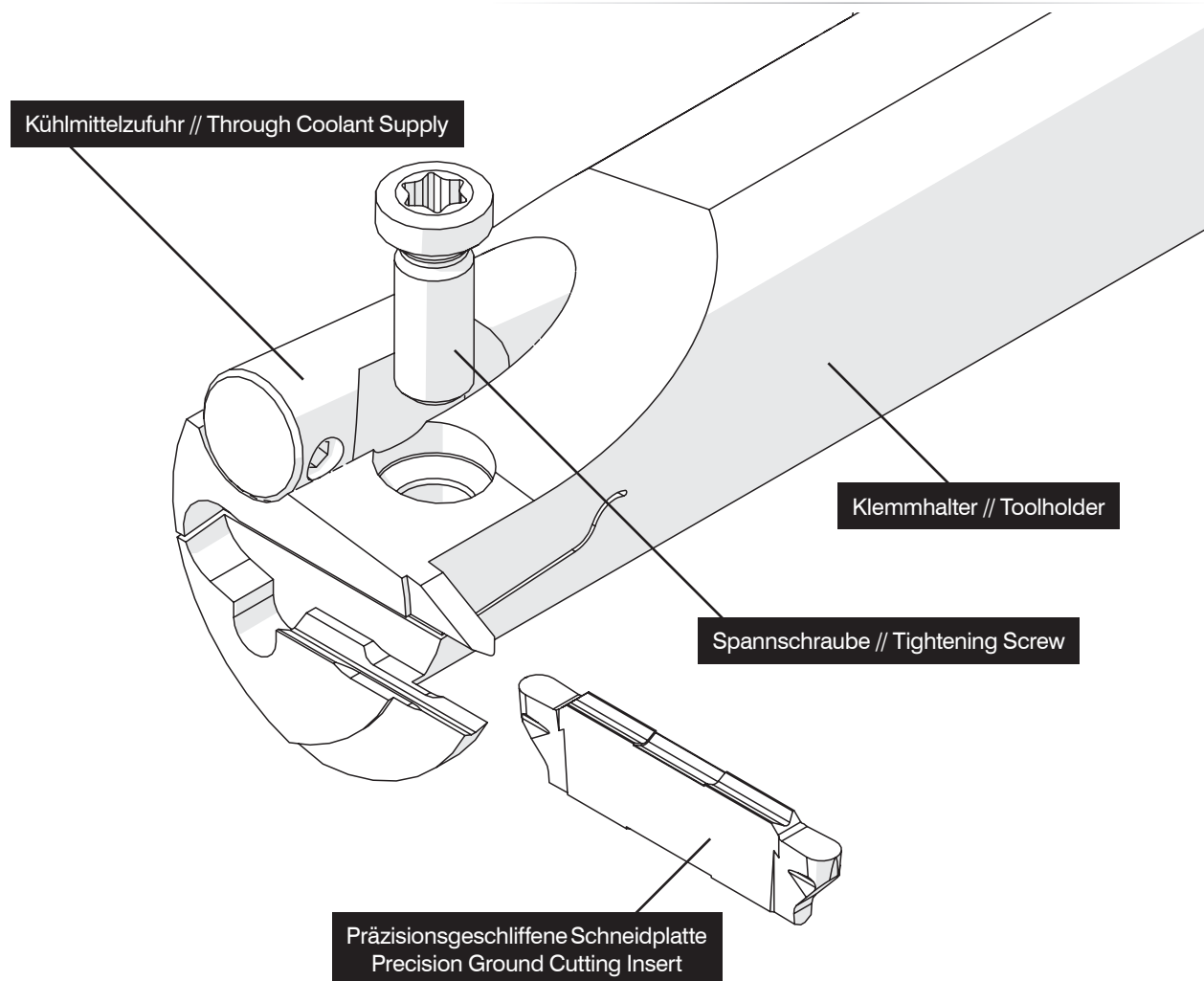

Verfügbar für die Innen- und Außenbearbeitung
Available for internal and external Applications

Innen // Internal

Ab Bohrungsdurchmesser 24,5 mm
As of bore diameter 24,5 mm

Außen // External

Maximale Stechtiefe 18,0 mm
Maximum Cutting Depth 18,0 mm

Standardanwendungen Standard Applications

Seite
Page

198

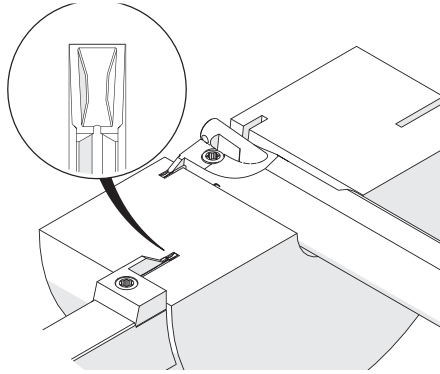

Stechdrehen, Sicherungsringnuten
Grooving, Circlip Ring Grooves

Seite
Page

199

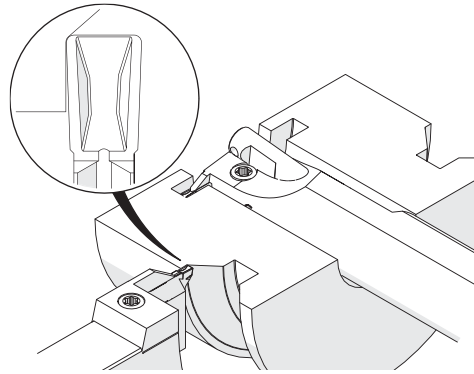

Einstecken und Profildrehen
Grooving and Profiling

Seite
Page

200

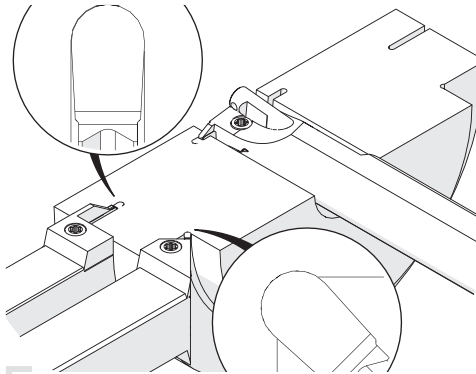

Einstecken und Profildrehen, Vollradius
Grooving and Profiling, Full Radius

Seite
Page

201

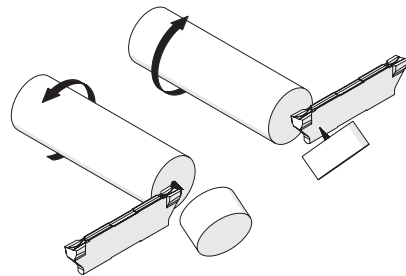

Abstechen
Part-Off

Seite
Page

202

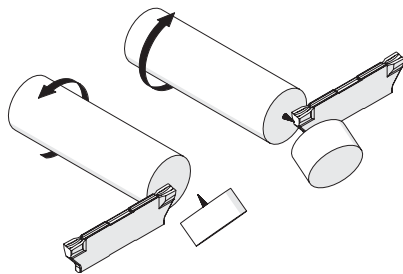

Abstechen
Part-Off

Klemmhalter, Innen, Typ A

Klemmhalter für die Innenbearbeitung ab Bohrungsdurchmesser 24,5 mm. Mit spezieller Kühlmitteldüse für verbesserte Spanbildung.

Toolholder, Internal, Type A

Toolholder for internal applications as of bore diameter 24,5 mm. Equipped with special through coolant nozzle for improved chip control.

Anzugsmoment (Schraube) // Tightening Torque (Screw)

4,5 Nm



Legende Legend 203

Scan QR-Code

Oder besuchen Sie // Or Visit www.simtek.info/cp/474

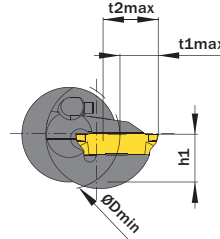
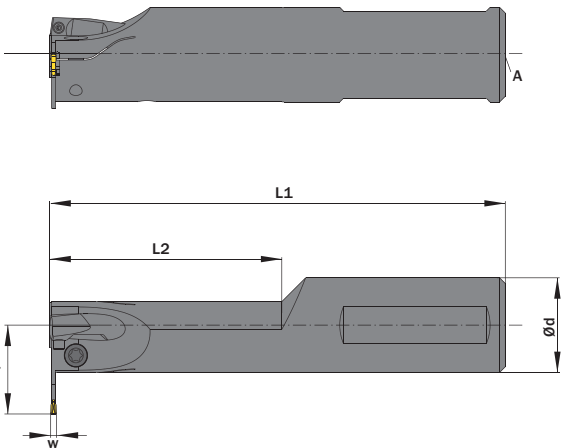

Für kleinere Bohrungen
For smaller bores

Detail A

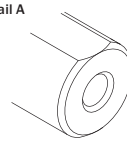

Anschlussgewinde G 1/8"
Connection thread G 1/8"

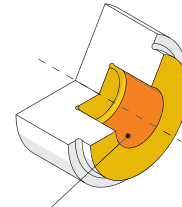

- Hauptsächlich geeignet für diese Flächen
Mainly designed for these Surfaces
- Je nach Schneidplatte ebenfalls möglich
Also possible depending on insert type

Abbildung zeigt / Drawing shows: TH2.0025.A31.61.12.15 R

Ød ^{g6}	ØDmin (Min. Bohrung) ØDmin (Min. Bore)	L2	L1	Artikelnummer Part number	Webcode www.simtek.eu/webcode	f	h1 ^{js14}	t1max	t2max	w ≥	w ≤	Schraube Screw	Schraubenschlüssel Screw driver	Connectcode www.simtek.eu/code
▼ Ød = 20,0 mm														
20,0	24,5	48,0	120,0	TH2.0020.A25.48.11.15 R/L	R ASVG L ASVF	18,0	9,0	7,0	12,5	-	1,9	TH2 M4x12 T15F	T15F	TH2.15
20,0	24,5	48,0	120,0	TH2.0020.A25.48.11.20 R/L	R ASVJ L ASVH	18,0	9,0	7,0	12,5	1,91	2,4	TH2 M4x12 T15F	T15F	TH2.20
20,0	24,5	48,0	120,0	TH2.0020.A25.48.11.25 R/L	R ASVM L ASVK	18,0	9,0	7,0	12,5	2,41	2,9	TH2 M4x12 T15F	T15F	TH2.25
20,0	24,5	48,0	120,0	TH2.0020.A25.48.11.30 R/L	R ASVP L ASVN	18,0	9,0	7,0	12,5	2,91	3,8	TH2 M4x12 T15F	T15F	TH2.30
20,0	24,5	48,0	120,0	TH2.0020.A25.48.11.40 R/L	R ASVS L ASVQ	18,0	9,0	7,0	12,5	3,81	4,9	TH2 M4x12 T15F	T15F	TH2.40
▼ Ød = 25,0 mm														
25,0	27,0	48,0	120,0	TH2.0025.A25.48.12.15 R/L	R ASWE L ASWD	20,5	11,5	7,0	15,0	-	1,9	TH2 M4x12 T15F	T15F	TH2.15
25,0	27,0	48,0	120,0	TH2.0025.A25.48.12.20 R/L	R ASWJ L ASWF	20,5	11,5	7,0	15,0	1,91	2,4	TH2 M4x12 T15F	T15F	TH2.20
25,0	27,0	48,0	120,0	TH2.0025.A25.48.12.25 R/L	R ASWJ L ASWH	20,5	11,5	7,0	15,0	2,41	2,9	TH2 M4x12 T15F	T15F	TH2.25
25,0	27,0	48,0	120,0	TH2.0025.A25.48.12.30 R/L	R ASWM L ASWK	20,5	11,5	7,0	15,0	2,91	3,8	TH2 M4x12 T15F	T15F	TH2.30
25,0	27,0	48,0	120,0	TH2.0025.A25.48.12.40 R/L	R ASWP L ASWN	20,5	11,5	7,0	15,0	3,81	4,9	TH2 M4x12 T15F	T15F	TH2.40
▼ Ød = 25,4 mm														
25,4	27,0	48,0	120,0	TH2.1.000.A25.48.12.15 R/L	R AW6A L AW59	20,7	11,7	7,0	15,0	-	1,9	TH2 M4x12 T15F	T15F	TH2.15
25,4	27,0	48,0	120,0	TH2.1.000.A25.48.12.20 R/L	R AW6C L AW6B	20,7	11,7	7,0	15,0	1,91	2,4	TH2 M4x12 T15F	T15F	TH2.20
25,4	27,0	48,0	120,0	TH2.1.000.A25.48.12.25 R/L	R AW6E L AW6D	20,7	11,7	7,0	15,0	2,41	2,9	TH2 M4x12 T15F	T15F	TH2.25
25,4	27,0	48,0	120,0	TH2.1.000.A25.48.12.30 R/L	R AW6G L AW6F	20,7	11,7	7,0	15,0	2,91	3,8	TH2 M4x12 T15F	T15F	TH2.30
25,4	27,0	48,0	120,0	TH2.1.000.A25.48.12.40 R/L	R AW6J L AW6H	20,7	11,7	7,0	15,0	3,81	4,9	TH2 M4x12 T15F	T15F	TH2.40

Verwandte Werkzeuge finden Sie auch auf der folgenden Seite!
Related Items can be found on the following page as well!

Fortgesetzte Tabelle
Continued Table

Bestellbeispiel // Order Example: TH2.0020.A25.48.11.25 R (R = Rechte Ausführung // Right Hand Version)

Klemmhalter, Innen, Typ A

Klemmhalter für die Innenbearbeitung ab Bohrungsdurchmesser 31,0 mm. Mit spezieller Kühlmitteldüse für verbesserte Spanbildung.

Toolholder, Internal, Type A

Toolholder for internal applications as of bore diameter 31,0 mm. Equipped with special through coolant nozzle for improved chip control.

Anzugsmoment (Schraube) // Tightening Torque (Screw)

"TH2 M4x12 T15F": 4,5 Nm
"TH2 M5x12 T20F": 7,0 Nm

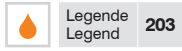

Scan QR-Code Oder besuchen Sie // Or Visit www.simtek.info/cp/860

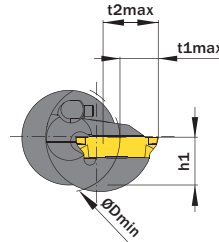
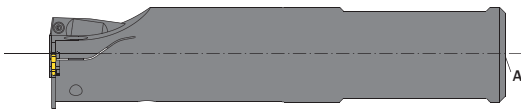

Für größere Bohrungen
For bigger bores

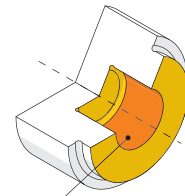
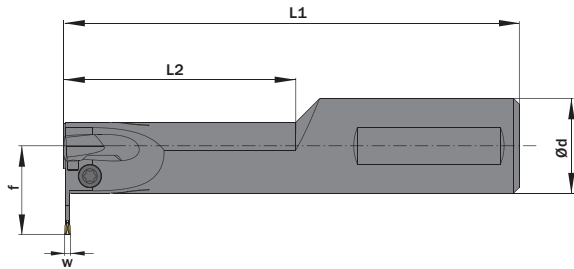

- Hauptsächlich geeignet für diese Flächen
Mainly designed for these Surfaces
- Je nach Schneidplatte ebenfalls möglich
Also possible depending on insert type

Abbildung zeigt / Drawing shows: TH2.0025.A31.61.12.15 R

Ød ^{g6}	ØDmin (Min. Bohrung) ØDmin (Min. Bore)	L2	L1	Artikelnummer Part number	Webcode www.simtek.eu/webcode	f	h1 ^{js14}	t1max	t2max	w ≥	w ≤	Schraube Screw	Schraubenschlüssel Screw driver	Connectcode www.simtek.eu/code
------------------	---	----	----	------------------------------	---	---	--------------------	-------	-------	-----	-----	-------------------	------------------------------------	---

Fortgesetzte Tabelle
Continued Table

Verwandte Werkzeuge finden Sie auch auf der vorhergehenden Seite!
Related items can be found on the previous page as well!

▼ Ød = 25,0 mm														
25,0	31,0	61,0	120,0	TH2.0025.A31.61.12.15 R/L	R ASWS L ASWQ	23,5	11,5	10,0	16,5	-	1,9	TH2 M4x12 T15F	T15F	TH2.15
25,0	31,0	61,0	120,0	TH2.0025.A31.61.12.20 R/L	R ASWU L ASWT	23,5	11,5	10,0	16,5	1,91	2,4	TH2 M4x12 T15F	T15F	TH2.20
25,0	31,0	61,0	120,0	TH2.0025.A31.61.12.25 R/L	R ASWW L ASWV	23,5	11,5	10,0	16,5	2,41	2,9	TH2 M4x12 T15F	T15F	TH2.25
25,0	31,0	61,0	120,0	TH2.0025.A31.61.12.30 R/L	R ASWY L ASWX	23,5	11,5	10,0	16,5	2,91	3,8	TH2 M4x12 T15F	T15F	TH2.30
25,0	31,0	61,0	120,0	TH2.0025.A31.61.12.40 R/L	R ASWØ L ASWZ	23,5	11,5	10,0	16,5	3,81	4,9	TH2 M4x12 T15F	T15F	TH2.40
▼ Ød = 25,4 mm														
25,4	31,0	61,0	120,0	TH2.1.000.A31.61.12.15 R/L	R AW6M L AW6K	23,7	11,7	10,0	16,5	-	1,9	TH2 M4x12 T15F	T15F	TH2.15
25,4	31,0	61,0	120,0	TH2.1.000.A31.61.12.20 R/L	R AW6P L AW6N	23,7	11,7	10,0	16,5	1,91	2,4	TH2 M4x12 T15F	T15F	TH2.20
25,4	31,0	61,0	120,0	TH2.1.000.A31.61.12.25 R/L	R AW6S L AW6Q	23,7	11,7	10,0	16,5	2,41	2,9	TH2 M4x12 T15F	T15F	TH2.25
25,4	31,0	61,0	120,0	TH2.1.000.A31.61.12.30 R/L	R AW6U L AW6T	23,7	11,7	10,0	16,5	2,91	3,8	TH2 M4x12 T15F	T15F	TH2.30
25,4	31,0	61,0	120,0	TH2.1.000.A31.61.12.40 R/L	R AW6W L AW6V	23,7	11,7	10,0	16,5	3,81	4,9	TH2 M4x12 T15F	T15F	TH2.40
▼ Ød = 32,0 mm														
32,0	34,0	61,0	120,0	TH2.0032.A31.61.12.15 R/L	R ASXØ L ASXZ	27,0	15,0	10,0	16,5	-	1,9	TH2 M5x12 T20F	T20F	TH2.15
32,0	34,0	61,0	120,0	TH2.0032.A31.61.12.20 R/L	R ASX2 L ASX1	27,0	15,0	10,0	16,5	1,91	2,4	TH2 M5x12 T20F	T20F	TH2.20
32,0	34,0	61,0	120,0	TH2.0032.A31.61.12.25 R/L	R ASX4 L ASX3	27,0	15,0	10,0	16,5	2,41	2,9	TH2 M5x12 T20F	T20F	TH2.25
32,0	34,0	61,0	120,0	TH2.0032.A31.61.12.30 R/L	R ASX6 L ASX5	27,0	15,0	10,0	16,5	2,91	3,8	TH2 M5x12 T20F	T20F	TH2.30
32,0	34,0	61,0	120,0	TH2.0032.A31.61.12.40 R/L	R ASX8 L ASX7	27,0	15,0	10,0	16,5	3,81	4,9	TH2 M5x12 T20F	T20F	TH2.40

Bestellbeispiel // Order Example: TH2.0025.A31.61.12.20 R (R = Rechte Ausführung // Right Hand Version)

Klemmhalter, Innen, Typ B

Klemmhalter für die Innenbearbeitung ab Bohrungsdurchmesser 24,5 mm. Ohne innere Kühlmittelzufuhr.

Toolholder, Internal, Type B

Toolholder for internal applications as of bore diameter 24,5 mm. Without through coolant.

Anzugsmoment (Schraube) // Tightening Torque (Screw)

4,5 Nm



TW
ST

R

Legende
Legend

203



Scan
QR-Code

Oder besuchen Sie // Or Visit
www.simtek.info/cp/477

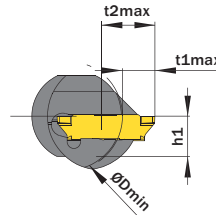
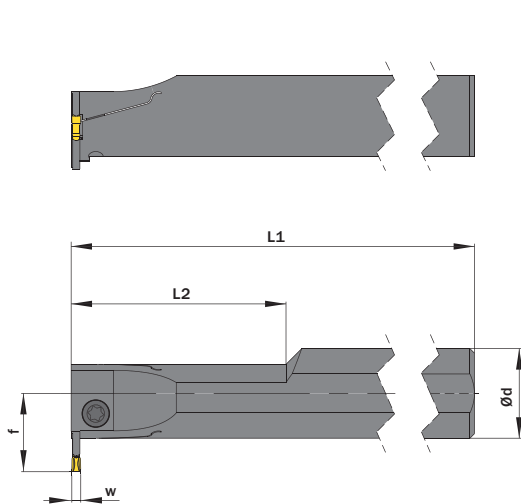

Für kleinere Bohrungen
For smaller bores

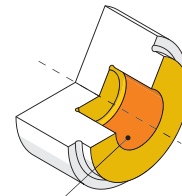

- Hauptsächlich geeignet für diese Flächen
Mainly designed for these Surfaces
- Je nach Schneidplatte ebenfalls möglich
Also possible depending on insert type

Abbildung zeigt / Drawing shows: TH2.0020.B25.48.11.20 R

Ød ^{g6}	ØDmin (Min. Bohrung) ØDmin (Min. Bore)	L2	L1	Artikelnummer Part number	Webcode www.simtek.eu/webcode	f	h1 ^{js14}	t1max	t2max	w ≥	w ≤	Schraube Screw	Schraubenschlüssel Screw driver	Connectcode www.simtek.eu/code
▼ Ød = 20,0 mm														
20,0	24,5	48,0	120,0	TH2.0020.B25.48.11.15 R/L	ASVU L ASVT	18,0	9,0	7,0	12,5	-	1,9	TH2 M4x12 T15F	T15F	TH2.15
20,0	24,5	48,0	120,0	TH2.0020.B25.48.11.20 R/L	ASVW L ASVV	18,0	9,0	7,0	12,5	1,91	2,4	TH2 M4x12 T15F	T15F	TH2.20
20,0	24,5	48,0	120,0	TH2.0020.B25.48.11.25 R/L	ASVY L ASVX	18,0	9,0	7,0	12,5	2,41	2,9	TH2 M4x12 T15F	T15F	TH2.25
20,0	24,5	48,0	120,0	TH2.0020.B25.48.11.30 R/L	ASVØ L ASVZ	18,0	9,0	7,0	12,5	2,91	3,8	TH2 M4x12 T15F	T15F	TH2.30
20,0	24,5	48,0	120,0	TH2.0020.B25.48.11.40 R/L	ASV2 L ASV1	18,0	9,0	7,0	12,5	3,81	4,9	TH2 M4x12 T15F	T15F	TH2.40
▼ Ød = 25,0 mm														
25,0	27,0	48,0	120,0	TH2.0025.B25.48.12.15 R/L	ASW2 L ASW1	20,5	11,5	7,0	15,0	-	1,9	TH2 M4x12 T15F	T15F	TH2.15
25,0	27,0	48,0	120,0	TH2.0025.B25.48.12.20 R/L	ASW4 L ASW3	20,5	11,5	7,0	15,0	1,91	2,4	TH2 M4x12 T15F	T15F	TH2.20
25,0	27,0	48,0	120,0	TH2.0025.B25.48.12.25 R/L	ASW6 L ASW5	20,5	11,5	7,0	15,0	2,41	2,9	TH2 M4x12 T15F	T15F	TH2.25
25,0	27,0	48,0	120,0	TH2.0025.B25.48.12.30 R/L	ASW8 L ASW7	20,5	11,5	7,0	15,0	2,91	3,8	TH2 M4x12 T15F	T15F	TH2.30
25,0	27,0	48,0	120,0	TH2.0025.B25.48.12.40 R/L	ASXA L ASW9	20,5	11,5	7,0	15,0	3,81	4,9	TH2 M4x12 T15F	T15F	TH2.40
▼ Ød = 25,4 mm														
25,4	27,0	48,0	120,0	TH2.1.000.B25.48.12.15 R/L	AW6Y L AW6X	20,7	11,7	7,0	15,0	-	1,9	TH2 M4x12 T15F	T15F	TH2.15
25,4	27,0	48,0	120,0	TH2.1.000.B25.48.12.20 R/L	AW6Ø L AW6Z	20,7	11,7	7,0	15,0	1,91	2,4	TH2 M4x12 T15F	T15F	TH2.20
25,4	27,0	48,0	120,0	TH2.1.000.B25.48.12.25 R/L	AW62 L AW61	20,7	11,7	7,0	15,0	2,41	2,9	TH2 M4x12 T15F	T15F	TH2.25
25,4	27,0	48,0	120,0	TH2.1.000.B25.48.12.30 R/L	AW64 L AW63	20,7	11,7	7,0	15,0	2,91	3,8	TH2 M4x12 T15F	T15F	TH2.30
25,4	27,0	48,0	120,0	TH2.1.000.B25.48.12.40 R/L	AW66 L AW65	20,7	11,7	7,0	15,0	3,81	4,9	TH2 M4x12 T15F	T15F	TH2.40

Verwandte Werkzeuge finden Sie auch auf der folgenden Seite!
Related Items can be found on the following page as well!

Fortgesetzte Tabelle
Continued Table

Bestellbeispiel // Order Example: TH2.0020.B25.48.11.30 R (R = Rechte Ausführung // Right Hand Version)

simturn® AX
simturn® DX
simturn® H2
simturn® K2
simturn® C4
simturn® GX
simturn® E3
simturn® E12
simturn® FX
simturn® Decolletage
simturn® OA
Anhang
Appendix

Klemmhalter, Innen, Typ B

Klemmhalter für die Innenbearbeitung ab Bohrungsdurchmesser 31,0 mm. Ohne innere Kühlmittelzufuhr.

Toolholder, Internal, Type B

Toolholder for internal applications as of bore diameter 31,0 mm. Without through coolant.

Anzugsmoment (Schraube) // Tightening Torque (Screw)

"TH2 M4x12 T15F": 4,5 Nm
"TH2 M5x12 T20F": 7,0 Nm



Legende
Legend **203**

Scan QR-Code Oder besuchen Sie // Or Visit www.simtek.info/cp/859

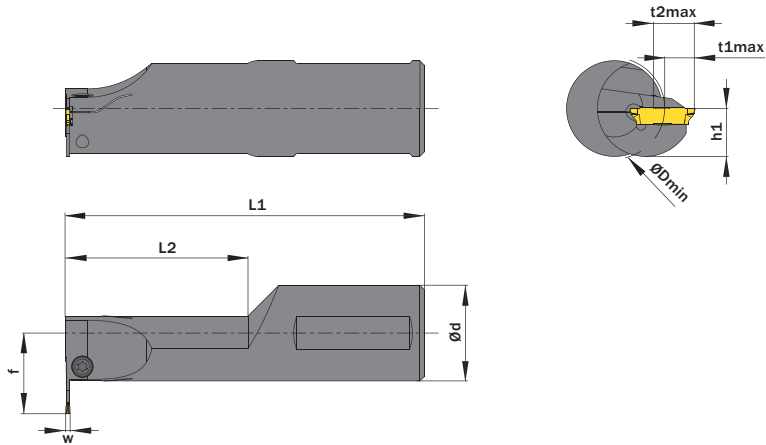

Für größere Bohrungen
For bigger bores

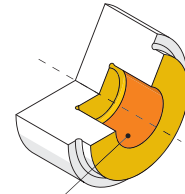

- Hauptsächlich geeignet für diese Flächen
Mainly designed for these Surfaces
- Je nach Schneidplatte ebenfalls möglich
Also possible depending on insert type

Abbildung zeigt / Drawing shows: TH2.0032.B31.61.12.15 R

Ød ^{g6}	ØDmin (Min. Bohrung) ØDmin (Min. Bore)	L2	L1	Artikelnummer Part number	Webcode www.simtek.eu/webcode	f	h1 ^{js14}	t1max	t2max	w ≥	w ≤	Schraube Screw	Schraubenschlüssel Screw driver	Connectcode www.simtek.eu/code
------------------	---	----	----	------------------------------	----------------------------------	---	--------------------	-------	-------	-----	-----	-------------------	------------------------------------	-----------------------------------

Fortgesetzte Tabelle // Continued Table
Verwandte Werkzeuge finden Sie auch auf der vorhergehenden Seite!
Related items can be found on the previous page as well!

▼ Ød = 25,0 mm														
25,0	31,0	61,0	120,0	TH2.0025.B31.61.12.15 R/L	R ASXC L ASXB	23,5	11,5	10,0	16,5	-	1,9	TH2 M4x12 T15F	T15F	TH2.15
25,0	31,0	61,0	120,0	TH2.0025.B31.61.12.20 R/L	R ASXE L ASXD	23,5	11,5	10,0	16,5	1,91	2,4	TH2 M4x12 T15F	T15F	TH2.20
25,0	31,0	61,0	120,0	TH2.0025.B31.61.12.25 R/L	R ASXG L ASXF	23,5	11,5	10,0	16,5	2,41	2,9	TH2 M4x12 T15F	T15F	TH2.25
25,0	31,0	61,0	120,0	TH2.0025.B31.61.12.30 R/L	R ASXJ L ASXH	23,5	11,5	10,0	16,5	2,91	3,8	TH2 M4x12 T15F	T15F	TH2.30
25,0	31,0	61,0	120,0	TH2.0025.B31.61.12.40 R/L	R ASXM L ASXK	23,5	11,5	10,0	16,5	3,81	4,9	TH2 M4x12 T15F	T15F	TH2.40
▼ Ød = 25,4 mm														
25,4	31,0	61,0	120,0	TH2.1.000.B31.61.12.15 R/L	AW68 L AW67	23,7	11,7	10,0	16,5	-	1,9	TH2 M4x12 T15F	T15F	TH2.15
25,4	31,0	61,0	120,0	TH2.1.000.B31.61.12.20 R/L	AW7A L AW69	23,7	11,7	10,0	16,5	1,91	2,4	TH2 M4x12 T15F	T15F	TH2.20
25,4	31,0	61,0	120,0	TH2.1.000.B31.61.12.25 R/L	AW7C L AW7B	23,7	11,7	10,0	16,5	2,41	2,9	TH2 M4x12 T15F	T15F	TH2.25
25,4	31,0	61,0	120,0	TH2.1.000.B31.61.12.30 R/L	AW7E L AW7D	23,7	11,7	10,0	16,5	2,91	3,8	TH2 M4x12 T15F	T15F	TH2.30
25,4	31,0	61,0	120,0	TH2.1.000.B31.61.12.40 R/L	AW7G L AW7F	23,7	11,7	10,0	16,5	3,81	4,9	TH2 M4x12 T15F	T15F	TH2.40
▼ Ød = 32,0 mm														
32,0	34,0	61,0	120,0	TH2.0032.B31.61.12.15 R/L	R ASYM L ASYK	27,0	15,0	10,0	16,5	-	1,9	TH2 M5x12 T20F	T20F	TH2.15
32,0	34,0	61,0	120,0	TH2.0032.B31.61.12.20 R/L	R ASYP L ASYN	27,0	15,0	10,0	16,5	1,91	2,4	TH2 M5x12 T20F	T20F	TH2.20
32,0	34,0	61,0	120,0	TH2.0032.B31.61.12.25 R/L	R ASYS L ASYQ	27,0	15,0	10,0	16,5	2,41	2,9	TH2 M5x12 T20F	T20F	TH2.25
32,0	34,0	61,0	120,0	TH2.0032.B31.61.12.30 R/L	R ASYU L ASYT	27,0	15,0	10,0	16,5	2,91	3,8	TH2 M5x12 T20F	T20F	TH2.30
32,0	34,0	61,0	120,0	TH2.0032.B31.61.12.40 R/L	R ASYW L ASYV	27,0	15,0	10,0	16,5	3,81	4,9	TH2 M5x12 T20F	T20F	TH2.40

Bestellbeispiel // Order Example: TH2.0032.B31.61.12.40 R (R = Rechte Ausführung // Right Hand Version)

Klemmhalter, Außen, Typ A

Klemmhalter für die Kleinteilebearbeitung. Aufnahme 10 x 10 mm.

Toolholder, External, Type A

Toolholder for Small Part Machining. Shank size 10 x 10 mm.

Anzugsmoment (Schraube) // Tightening Torque (Screw)

4,5 Nm



TW **ST** **R** Legende
Legend **203**

Scan QR-Code Oder besuchen Sie // Or Visit
www.simtek.info/cp/468

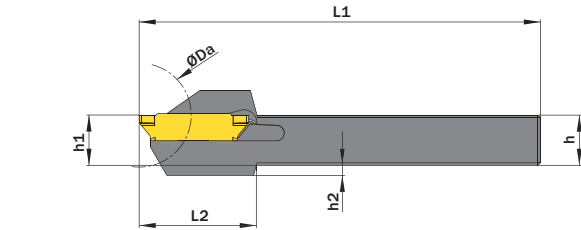

ØDa	tmax
Ø16,0 mm / Ø0.6299"	11,0 mm / 0.4331"
Ø20,0 mm / Ø0.7874"	8,0 mm / 0.3150"
Ø30,0 mm / Ø1.1811"	6,0 mm / 0.2362"
Ø40,0 mm / Ø1.5748"	5,0 mm / 0.1969"
Ø90,0 mm / Ø3.5433"	4,0 mm / 0.1575"
Ø150,0 mm / Ø5.9055"	3,5 mm / 0.1378"

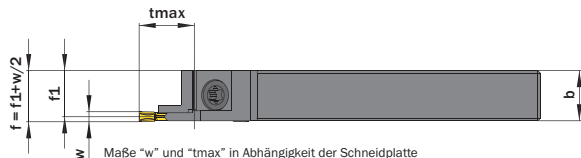

Maße "w" und "tmax" in Abhängigkeit der Schneidplatte
Dimensions "w" and "tmax" depends on cutting insert

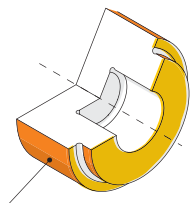
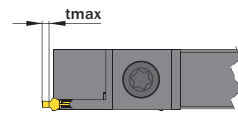

- Hauptsächlich geeignet für diese Flächen
Mainly designed for these Surfaces
- Je nach Schneidplatte/Aufnahme ebenfalls möglich
Also possible depending on insert/fixation type

Abbildung zeigt / Drawing shows: TH2.1010.A11.08.20 R

h	b	L1	Artikelnummer Part number	Webcode www.simtek.eu/webcode	f1	h1 ^{is14}	h2	L2	w ≥	w ≤	Schraube Screw	Schraubenschlüssel Screw driver	Connectcode www.simtek.eu/code
mm	mm	mm			mm	mm	mm	mm	mm	mm			
▼ L1 = 80,0 mm													
10,0	10,0	80,0	TH2.1010.A11.08.15 R/L	R ASNK L ASNJ	9,45	10,0	2,0	23,5	-	1,9	TH2 M4x12 T15F	T15F	TH2.15
10,0	10,0	80,0	TH2.1010.A11.08.20 R/L	R ASDH L ASNM	9,2	10,0	2,0	23,5	1,91	2,4	TH2 M4x12 T15F	T15F	TH2.20
10,0	10,0	80,0	TH2.1010.A11.08.25 R/L	R ASNP L ASNN	8,95	10,0	2,0	23,5	2,41	2,9	TH2 M4x12 T15F	T15F	TH2.25
10,0	10,0	80,0	TH2.1010.A11.08.30 R/L	R ASNS L ASNQ	8,7	10,0	2,0	23,5	2,91	3,8	TH2 M4x12 T15F	T15F	TH2.30
▼ L1 = 125,0 mm													
10,0	10,0	125,0	TH2.1010.A11.12.15 R/L	R AUHH L AUHG	9,45	10,0	2,0	23,5	-	1,9	TH2 M4x12 T15F	T15F	TH2.15
10,0	10,0	125,0	TH2.1010.A11.12.20 R/L	R AUHK L AUHJ	9,2	10,0	2,0	23,5	1,91	2,4	TH2 M4x12 T15F	T15F	TH2.20
10,0	10,0	125,0	TH2.1010.A11.12.25 R/L	R AUHN L AUHM	8,95	10,0	2,0	23,5	2,41	2,9	TH2 M4x12 T15F	T15F	TH2.25
10,0	10,0	125,0	TH2.1010.A11.12.30 R/L	R AUHQ L AUHP	8,7	10,0	2,0	23,5	2,91	3,8	TH2 M4x12 T15F	T15F	TH2.30

Verwandte Werkzeuge finden Sie auch auf der folgenden Seite!
Related Items can be found on the following page as well!

Fortgesetzte Tabelle
Continued Table

Bestellbeispiel // Order Example: **TH2.1010.A11.12.20 R** (R = Rechte Ausführung // Right Hand Version)

simturn® AX
simturn® DX
simturn® H2
simturn® K2
simturn® C4
simturn® GX
simturn® E3
simturn® E12
simturn® FX
simturn® Decolletage
simturn® OA
Anhang Appendix

Klemmhalter, Außen, Typ A

Klemmhalter für die Kleinteilebearbeitung. Aufnahme 12 x 12 mm.

Toolholder, External, Type A

Toolholder for Small Part Machining. Shank size 12 x 12 mm.

Anzugsmoment (Schraube) // Tightening Torque (Screw)

4,5 Nm



Legende
Legend **203**



Scan
QR-Code

Oder besuchen Sie // Or Visit
www.simtek.info/cp/469

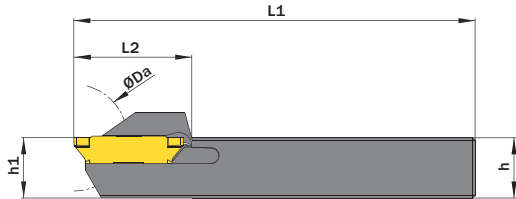

ØDa	tmax
Ø24,0 mm / Ø0.9449"	13,0 mm / 0.5118"
Ø30,0 mm / Ø1.1811"	10,0 mm / 0.3937"
Ø44,0 mm / Ø1.7323"	8,0 mm / 0.3150"
Ø62,0 mm / Ø2.4409"	7,0 mm / 0.2756"
Ø110,0 mm / Ø4.3307"	6,0 mm / 0.2362"
Ø200,0 mm / Ø7.8740"	5,5 mm / 0.2165"

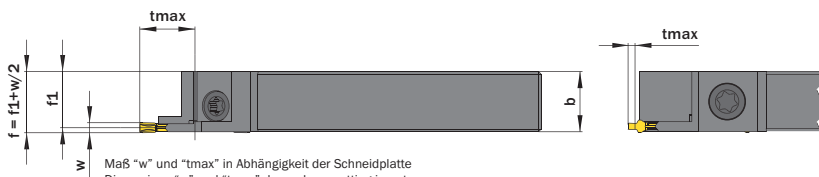

Maß "w" und "tmax" in Abhängigkeit der Schneidplatte
Dimensions "w" and "tmax" depends on cutting insert

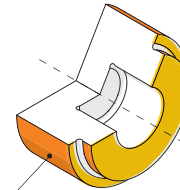

- Hauptsächlich geeignet für diese Flächen
Mainly designed for these Surfaces
- Je nach Schneidplatte/Aufnahme ebenfalls möglich
Also possible depending on insert/fixation type

Abbildung zeigt / Drawing shows: TH2.1212.A13.08.20 R

h	b	L1	Artikelnummer Part number	Webcode www.simtek.de/webcode	f1	h1 ^{s14}	L2	w ≥	w ≤	Schraube Screw	Schraubenschlüssel Screw driver	Connectcode www.simtek.de/code
mm	mm	mm			mm	mm	mm	mm	mm			

Fortgesetzte Tabelle
Continued Table

Verwandte Werkzeuge finden Sie auch auf der vorhergehenden Seite!
Related items can be found on the previous page as well!

▼ L1 = 80,0 mm

12,0	12,0	80,0	TH2.1212.A13.08.15 R/L	R ASN6 L ASN5	11,45	12,0	25,5	-	1,9	TH2 M4x12 T15F	T15F	TH2.15
12,0	12,0	80,0	TH2.1212.A13.08.20 R/L	R ASN8 L ASN7	11,2	12,0	25,5	1,91	2,4	TH2 M4x12 T15F	T15F	TH2.20
12,0	12,0	80,0	TH2.1212.A13.08.25 R/L	R ASPA L ASN9	10,95	12,0	25,5	2,41	2,9	TH2 M4x12 T15F	T15F	TH2.25
12,0	12,0	80,0	TH2.1212.A13.08.30 R/L	R ASPC L ASPB	10,7	12,0	25,5	2,91	3,8	TH2 M4x12 T15F	T15F	TH2.30
12,0	12,0	80,0	TH2.1212.A13.08.40 R/L	R ASPE L ASPD	10,2	12,0	25,5	3,81	4,9	TH2 M4x12 T15F	T15F	TH2.40

▼ L1 = 125,0 mm

12,0	12,0	125,0	TH2.1212.A13.12.15 R/L	R AUHT L AUHS	11,45	12,0	25,5	-	1,9	TH2 M4x12 T15F	T15F	TH2.15
12,0	12,0	125,0	TH2.1212.A13.12.20 R/L	R AUHV L AUHU	11,2	12,0	25,5	1,91	2,4	TH2 M4x12 T15F	T15F	TH2.20
12,0	12,0	125,0	TH2.1212.A13.12.25 R/L	R AUHX L AUHW	10,95	12,0	25,5	2,41	2,9	TH2 M4x12 T15F	T15F	TH2.25
12,0	12,0	125,0	TH2.1212.A13.12.30 R/L	R AUHZ L AUHY	10,7	12,0	25,5	2,91	3,8	TH2 M4x12 T15F	T15F	TH2.30
12,0	12,0	125,0	TH2.1212.A13.12.40 R/L	R AUH1 L AUH0	10,2	12,0	25,5	3,81	4,9	TH2 M4x12 T15F	T15F	TH2.40

■ Bestellbeispiel // Order Example: TH2.1212.A13.08.20 R (R = Rechte Ausführung // Right Hand Version)

Klemmhalter, Außen, Typ B

Klemmhalter für die Außenbearbeitung.
Auf maximale Stechtiefe ausgelegt.

Toolholder, External, Type B

Toolholder for external applications.
Designed for highest cutting depths.

Anzugsmoment (Schraube) // Tightening Torque (Screw)

4,5 Nm



Legende
Legend **203**

Scan QR-Code Oder besuchen Sie // Or Visit
www.simtek.info/cp/861

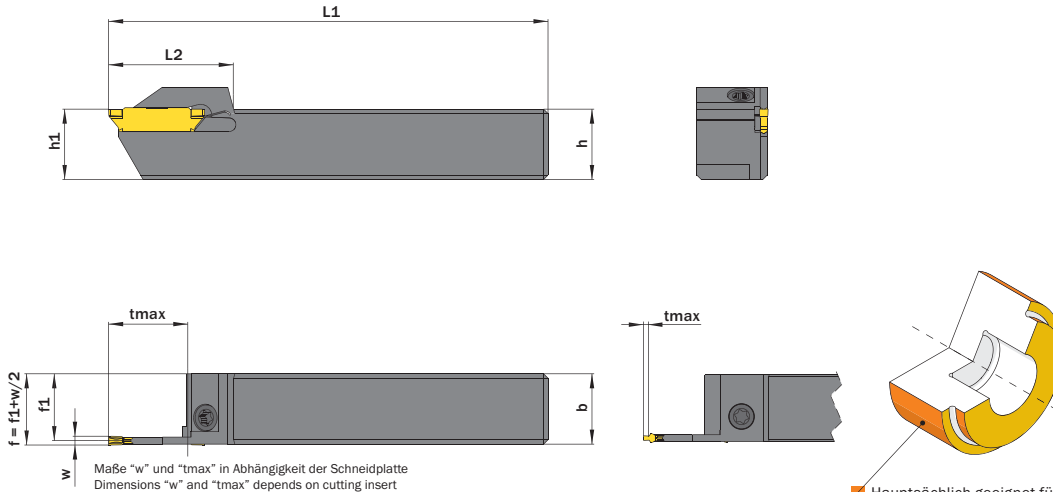

Maße "w" und "tmax" in Abhängigkeit der Schneidplatte
Dimensions "w" and "tmax" depends on cutting insert

- Hauptsächlich geeignet für diese Flächen
Mainly designed for these Surfaces
- Je nach Schneidplatte/Aufnahme ebenfalls möglich
Also possible depending on insert/fixation type

Abbildung zeigt / Drawing shows: TH2.1616.B18.12.20 R

h	b	tmax	L1	Artikelnummer Part number	Webcode www.simtek.eu/webcode	f1	h1 ^{js14}	L2	w ≥	w ≤	Schraube Screw	Schraubenschlüssel Screw driver	Connectcode www.simtek.eu/code
mm	mm	mm	mm			mm	mm	mm	mm	mm			
▼ h = 16,0 mm													
16,0	16,0	18,0	125,0	TH2.1616.B18.12.15 R/L	R ASQE L ASQD	15,45	16,0	28,5	-	1,9	TH2 M4x16,6 T15F	T15F	TH2.15
16,0	16,0	18,0	125,0	TH2.1616.B18.12.20 R/L	R ASQG L ASQF	15,2	16,0	28,5	1,91	2,4	TH2 M4x16,6 T15F	T15F	TH2.20
16,0	16,0	18,0	125,0	TH2.1616.B18.12.25 R/L	R ASQJ L ASQH	14,95	16,0	28,5	2,41	2,9	TH2 M4x16,6 T15F	T15F	TH2.25
16,0	16,0	18,0	125,0	TH2.1616.B18.12.30 R/L	R ASQM L ASQK	14,7	16,0	28,5	2,91	3,8	TH2 M4x16,6 T15F	T15F	TH2.30
16,0	16,0	18,0	125,0	TH2.1616.B18.12.40 R/L	R ASQP L ASQN	14,2	16,0	28,5	3,81	4,9	TH2 M4x16,6 T15F	T15F	TH2.40
▼ h = 19,05 mm													
19,05	19,05	18,0	125,0	TH2.0.750.S.B18.12.15 R/L	R AW7P L AW8M	18,5	19,05	28,5	-	1,9	TH2 M4x16,6 T15F	T15F	TH2.15
19,05	19,05	18,0	125,0	TH2.0.750.S.B18.12.20 R/L	R AW7Q L AW8N	18,25	19,05	28,5	1,91	2,4	TH2 M4x16,6 T15F	T15F	TH2.20
19,05	19,05	18,0	125,0	TH2.0.750.S.B18.12.25 R/L	R AW7S L AW8P	18,0	19,05	28,5	2,41	2,9	TH2 M4x16,6 T15F	T15F	TH2.25
19,05	19,05	18,0	125,0	TH2.0.750.S.B18.12.30 R/L	R AW7T L AW8Q	17,75	19,05	28,5	2,91	3,8	TH2 M4x16,6 T15F	T15F	TH2.30
19,05	19,05	18,0	125,0	TH2.0.750.S.B18.12.40 R/L	R AW7U L AW8S	17,25	19,05	28,5	3,81	4,9	TH2 M4x16,6 T15F	T15F	TH2.40
▼ h = 20,0 mm													
20,0	20,0	18,0	125,0	TH2.2020.B18.12.15 R/L	R ASSP L ASSN	19,45	20,0	28,5	-	1,9	TH2 M4x16,6 T15F	T15F	TH2.15
20,0	20,0	18,0	125,0	TH2.2020.B18.12.20 R/L	R ASSS L ASSQ	19,2	20,0	28,5	1,91	2,4	TH2 M4x16,6 T15F	T15F	TH2.20
20,0	20,0	18,0	125,0	TH2.2020.B18.12.25 R/L	R ASSU L ASST	18,95	20,0	28,5	2,41	2,9	TH2 M4x16,6 T15F	T15F	TH2.25
20,0	20,0	18,0	125,0	TH2.2020.B18.12.30 R/L	R ASSW L ASSV	18,7	20,0	28,5	2,91	3,8	TH2 M4x16,6 T15F	T15F	TH2.30
20,0	20,0	18,0	125,0	TH2.2020.B18.12.40 R/L	R ASSY L ASSX	18,2	20,0	28,5	3,81	4,9	TH2 M4x16,6 T15F	T15F	TH2.40

Verwandte Werkzeuge finden Sie auch auf der folgenden Seite!
Related Items can be found on the following page as well!

Fortgesetzte Tabelle
Continued Table

Bestellbeispiel // Order Example: **TH2.2020.B18.12.20 R** (R = Rechte Ausführung // Right Hand Version)

Klemmhalter, Außen, Typ B

Klemmhalter für die Außenbearbeitung.
Auf maximale Stechtiefe ausgelegt.

Toolholder, External, Type B

Toolholder for external applications.
Designed for highest cutting depths.

Anzugsmoment (Schraube) // Tightening Torque (Screw)

4,5 Nm



Legende
Legend **203**



Scan
QR-Code

Oder besuchen Sie // Or Visit
www.simtek.info/cp/1037

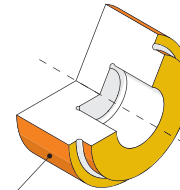
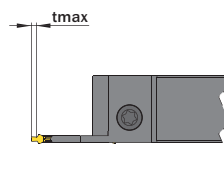
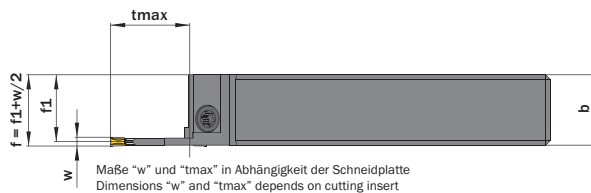
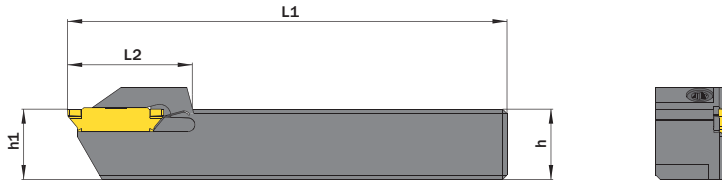

- Hauptsächlich geeignet für diese Flächen
Mainly designed for these Surfaces
- Je nach Schneidplatte/Aufnahme ebenfalls möglich
Also possible depending on insert/fixation type

Abbildung zeigt / Drawing shows: TH2.1616.B18.10.20 R

h	b	tmax	L1	Artikelnummer Part number	Webcode www.simtek.eu/webcode	f1	h1 ^{js14}	L2	w ≥	w ≤	Schraube Screw	Schraubenschlüssel Screw driver	Connectcode www.simtek.eu/code
mm	mm	mm	mm			mm	mm	mm	mm	mm			

Fortgesetzte Tabelle
Continued Table

Verwandte Werkzeuge finden Sie auch auf der vorhergehenden Seite!
Related items can be found on the previous page as well!

▼ h = 25,0 mm													
25,0	25,0	18,0	150,0	TH2.2525.B18.15.15 R/L	R ASTY L ASTX	24,45	25,0	28,5	-	1,9	TH2 M4x16.6 T15F	T15F	TH2.15
25,0	25,0	18,0	150,0	TH2.2525.B18.15.20 R/L	R AST0 L ASTZ	24,2	25,0	28,5	1,91	2,4	TH2 M4x16.6 T15F	T15F	TH2.20
25,0	25,0	18,0	150,0	TH2.2525.B18.15.25 R/L	R AST2 L AST1	23,95	25,0	28,5	2,41	2,9	TH2 M4x16.6 T15F	T15F	TH2.25
25,0	25,0	18,0	150,0	TH2.2525.B18.15.30 R/L	R AST4 L AST3	23,7	25,0	28,5	2,91	3,8	TH2 M4x16.6 T15F	T15F	TH2.30
25,0	25,0	18,0	150,0	TH2.2525.B18.15.40 R/L	R AST6 L AST5	23,2	25,0	28,5	3,81	4,9	TH2 M4x16.6 T15F	T15F	TH2.40
▼ h = 25,4 mm													
25,4	25,4	18,0	150,0	TH2.1.000.S.B18.15.15 R/L	R AW7H L AW8F	24,85	25,4	28,5	-	1,9	TH2 M4x16.6 T15F	T15F	TH2.15
25,4	25,4	18,0	150,0	TH2.1.000.S.B18.15.20 R/L	R AW7J L AW8G	24,6	25,4	28,5	1,91	2,4	TH2 M4x16.6 T15F	T15F	TH2.20
25,4	25,4	18,0	150,0	TH2.1.000.S.B18.15.25 R/L	R AW7K L AW8H	24,35	25,4	28,5	2,41	2,9	TH2 M4x16.6 T15F	T15F	TH2.25
25,4	25,4	18,0	150,0	TH2.1.000.S.B18.15.30 R/L	R AW7M L AW8J	24,1	25,4	28,5	2,91	3,8	TH2 M4x16.6 T15F	T15F	TH2.30
25,4	25,4	18,0	150,0	TH2.1.000.S.B18.15.40 R/L	R AW7N L AW8K	23,6	25,4	28,5	3,81	4,9	TH2 M4x16.6 T15F	T15F	TH2.40

Bestellbeispiel // Order Example: TH2.2525.B18.15.30 R (R = Rechte Ausführung // Right Hand Version)

Klemmhalter, Außen, Typ C

Klemmhalter für die Außenbearbeitung. Reduzierte Stechtiefe für höchste Stabilität.

Toolholder, External, Type C

Toolholder for external applications. Reduced Cutting depth, designed for highest stability.

Anzugsmoment (Schraube) // Tightening Torque (Screw)

4,5 Nm



TW
ST

R

Legende
Legend

203



Scan
QR-Code

Oder besuchen Sie // Or Visit
www.simtek.info/cp/862

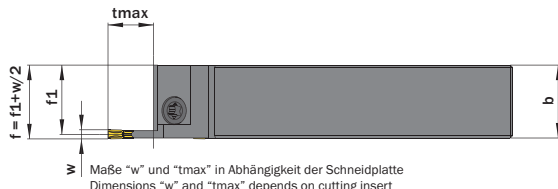
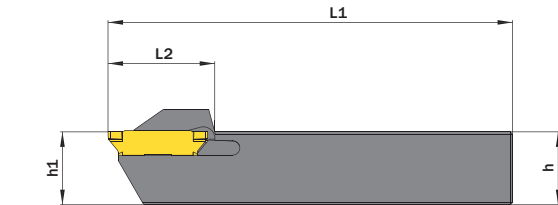

Maße "w" und "tmax" in Abhängigkeit der Schneidplatte
Dimensions "w" and "tmax" depends on cutting insert

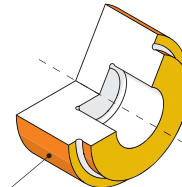
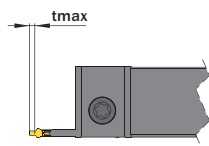

■ Hauptsächlich geeignet für diese Flächen
Mainly designed for these Surfaces

■ Je nach Schneidplatte/Aufnahme ebenfalls möglich
Also possible depending on insert/fixation type

Abbildung zeigt / Drawing shows: TH2.1616.C10.10.20 R

h	b	tmax	L1	Artikelnummer Part number	Webcode www.simtek.eu/webcode	f1	h1 ^{js14}	L2	w ≥	w ≤	Schraube Screw	Schraubenschlüssel Screw driver	Connectcode www.simtek.eu/code
mm	mm	mm	mm			mm	mm	mm	mm	mm			
▼ h = 16,0 mm													
16,0	16,0	10,0	125,0	TH2.1616.C10.12.15 R/L	R ASQ2 L ASQ1	15,45	16,0	28,5	-	1,9	TH2 M4x16,6 T15F	T15F	TH2.15
16,0	16,0	10,0	125,0	TH2.1616.C10.12.20 R/L	R ASQ4 L ASQ3	15,2	16,0	28,5	1,91	2,4	TH2 M4x16,6 T15F	T15F	TH2.20
16,0	16,0	10,0	125,0	TH2.1616.C10.12.25 R/L	R ASQ6 L ASQ5	14,95	16,0	28,5	2,41	2,9	TH2 M4x16,6 T15F	T15F	TH2.25
16,0	16,0	10,0	125,0	TH2.1616.C10.12.30 R/L	R ASQ8 L ASQ7	14,7	16,0	28,5	2,91	3,8	TH2 M4x16,6 T15F	T15F	TH2.30
16,0	16,0	10,0	125,0	TH2.1616.C10.12.40 R/L	R ASSA L ASQ9	14,2	16,0	28,5	3,81	4,9	TH2 M4x16,6 T15F	T15F	TH2.40
▼ h = 19,05 mm													
19,05	19,05	10,0	125,0	TH2.0.750.S.C10.12.15 R/L	R AW70 L AW8Y	18,5	19,05	28,5	-	1,9	TH2 M4x16,6 T15F	T15F	TH2.15
19,05	19,05	10,0	125,0	TH2.0.750.S.C10.12.20 R/L	R AW71 L AW8Z	18,25	19,05	28,5	1,91	2,4	TH2 M4x16,6 T15F	T15F	TH2.20
19,05	19,05	10,0	125,0	TH2.0.750.S.C10.12.25 R/L	R AW72 L AW80	18,0	19,05	28,5	2,41	2,9	TH2 M4x16,6 T15F	T15F	TH2.25
19,05	19,05	10,0	125,0	TH2.0.750.S.C10.12.30 R/L	R AW73 L AW81	17,75	19,05	28,5	2,91	3,8	TH2 M4x16,6 T15F	T15F	TH2.30
19,05	19,05	10,0	125,0	TH2.0.750.S.C10.12.40 R/L	R AW74 L AW82	17,5	19,05	28,5	3,81	4,9	TH2 M4x16,6 T15F	T15F	TH2.40
▼ h = 20,0 mm													
20,0	20,0	10,0	125,0	TH2.2020.C10.12.15 R/L	R ASTA L ASS9	19,45	20,0	28,5	-	1,9	TH2 M4x16,6 T15F	T15F	TH2.15
20,0	20,0	10,0	125,0	TH2.2020.C10.12.20 R/L	R ASTC L ASTB	19,2	20,0	28,5	1,91	2,4	TH2 M4x16,6 T15F	T15F	TH2.20
20,0	20,0	10,0	125,0	TH2.2020.C10.12.25 R/L	R ASTE L ASTD	18,95	20,0	28,5	2,41	2,9	TH2 M4x16,6 T15F	T15F	TH2.25
20,0	20,0	10,0	125,0	TH2.2020.C10.12.30 R/L	R ASTG L ASTF	18,7	20,0	28,5	2,91	3,8	TH2 M4x16,6 T15F	T15F	TH2.30
20,0	20,0	10,0	125,0	TH2.2020.C10.12.40 R/L	R ASTJ L ASTH	18,2	20,0	28,5	3,81	4,9	TH2 M4x16,6 T15F	T15F	TH2.40

Verwandte Werkzeuge finden Sie auch auf der folgenden Seite!
Related Items can be found on the following page as well!

Fortgesetzte Tabelle
Continued Table

Bestellbeispiel // Order Example: TH2.1616.C10.12.20 R (R = Rechte Ausführung // Right Hand Version)

Klemmhalter, Außen, Typ C

Klemmhalter für die Außenbearbeitung. Reduzierte Stechtiefe für höchste Stabilität.

Toolholder, External, Type C

Toolholder for external applications. Reduced Cutting depth, designed for highest stability.

Anzugsmoment (Schraube) // Tightening Torque (Screw)

4,5 Nm



TW
ST

R

Legende
Legend

203



Scan
QR-Code

Oder besuchen Sie // Or Visit
www.simtek.info/cp/1057

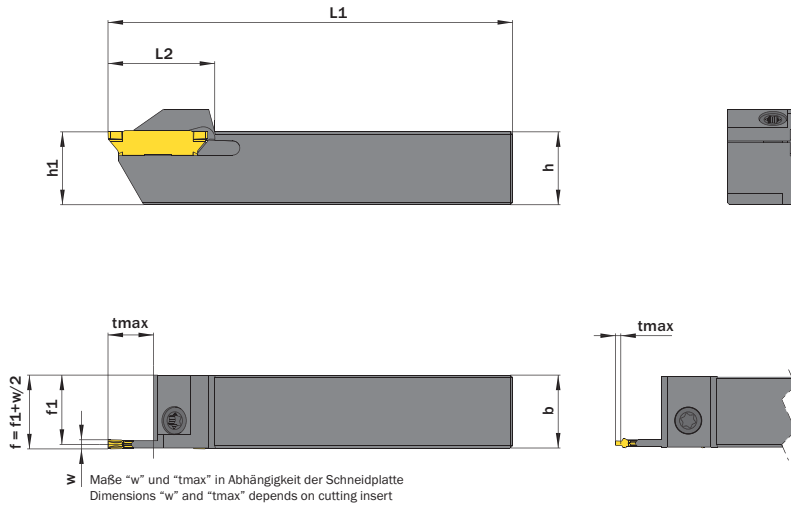

Maße "w" und "tmax" in Abhängigkeit der Schneidplatte
Dimensions "w" and "tmax" depends on cutting insert

- Hauptsächlich geeignet für diese Flächen
Mainly designed for these Surfaces
- Je nach Schneidplatte/Aufnahme ebenfalls möglich
Also possible depending on insert/fixation type

Abbildung zeigt / Drawing shows: TH2.1616.C10.10.20 R

h	b	tmax	L1	Artikelnummer Part number	Webcode www.simtek.eu/webcode	f1	h1 ^{js14}	L2	w ≥	w ≤	Schraube Screw	Schraubenschlüssel Screw driver	Connectcode www.simtek.eu/code
mm	mm	mm	mm			mm	mm	mm	mm	mm			

Fortgesetzte Tabelle
Continued Table

Verwandte Werkzeuge finden Sie auch auf der vorhergehenden Seite!
Related items can be found on the previous page as well!

▼ h = 25,0 mm														
25,0	25,0	10,0	150,0	TH2.2525.C10.15.15 R/L	R ASUJ	L ASUH	24,45	25,0	23,6	-	1,9	TH2 M4x16.6 T15F	T15F	TH2.15
25,0	25,0	10,0	150,0	TH2.2525.C10.15.20 R/L	R ASUM	L ASUK	24,2	25,0	23,6	1,91	2,4	TH2 M4x16.6 T15F	T15F	TH2.20
25,0	25,0	10,0	150,0	TH2.2525.C10.15.25 R/L	R ASUP	L ASUN	23,95	25,0	23,6	2,41	2,9	TH2 M4x16.6 T15F	T15F	TH2.25
25,0	25,0	10,0	150,0	TH2.2525.C10.15.30 R/L	R ASUS	L ASUQ	23,7	25,0	23,6	2,91	3,8	TH2 M4x16.6 T15F	T15F	TH2.30
25,0	25,0	10,0	150,0	TH2.2525.C10.15.40 R/L	R ASUU	L ASUT	23,2	25,0	23,6	3,81	4,9	TH2 M4x16.6 T15F	T15F	TH2.40
▼ h = 25,4 mm														
25,4	25,4	10,0	150,0	TH2.1.000.S.C10.15.15 R/L	R AW7V	L AW8T	24,85	25,4	28,5	-	1,9	TH2 M4x16.6 T15F	T15F	TH2.15
25,4	25,4	10,0	150,0	TH2.1.000.S.C10.15.20 R/L	R AW7W	L AW8U	24,6	25,4	28,5	1,91	2,4	TH2 M4x16.6 T15F	T15F	TH2.20
25,4	25,4	10,0	150,0	TH2.1.000.S.C10.15.25 R/L	R AW7X	L AW8V	24,35	25,4	28,5	2,41	2,9	TH2 M4x16.6 T15F	T15F	TH2.25
25,4	25,4	10,0	150,0	TH2.1.000.S.C10.15.30 R/L	R AW7Y	L AW8W	24,1	25,4	28,5	2,91	3,8	TH2 M4x16.6 T15F	T15F	TH2.30
25,4	25,4	10,0	150,0	TH2.1.000.S.C10.15.40 R/L	R AW7Z	L AW8X	23,6	25,4	28,5	3,81	4,9	TH2 M4x16.6 T15F	T15F	TH2.40

Bestellbeispiel // Order Example: TH2.2525.C10.15.15 R (R = Rechte Ausführung // Right Hand Version)

Klemmhalter, Eckenfreistriche außen

Klemmhalter für Eckenfreistriche außen. Geeignet für Vollradiusschneidplatten sowie für passende Individualwerkzeuge.

Toolholder, External Corner Relief

Toolholder for external corner reliefs. For use with Full Radius inserts and for suitable customized tools.

Anzugsmoment (Schraube) // Tightening Torque (Screw)

"TH2 M4x12 T15F": 4,5 Nm
"TH2 M4x16,6 T15F": 4,5 Nm



Legende
Legend **203**

Scan QR-Code Oder besuchen Sie // Or Visit
www.simtek.info/cp/473

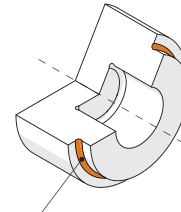
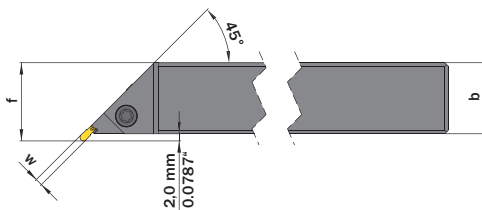
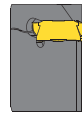
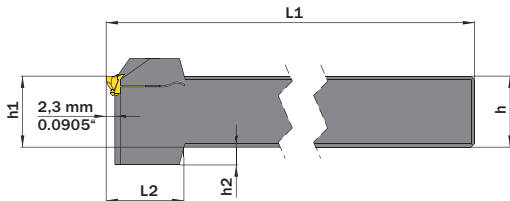

Hauptsächlich geeignet für diese Flächen
Mainly designed for these Surfaces

Abbildung zeigt / Drawing shows: TH2.2020.D45.12.20 R

h	b	L1	Artikelnummer Part number	Webcode www.simtek.eu/webcode	f	h1 ^{is14}	h2	L2	w ≥	w ≤	Schraube Screw	Schraubenschlüssel Screw driver	Connectcode www.simtek.eu/code	
mm	mm	mm			mm	mm	mm	mm	mm	mm				
▼ h = 19,05 mm														
19,05	19,05	125,0	TH2.0.750.S.D45.12.15 R/L	R AW8A L AW88	21,05	19,05	5,0	30,0	-	1,9	TH2 M4x12 T15F	T15F	TH2.15	
19,05	19,05	125,0	TH2.0.750.S.D45.12.20 R/L	R AW8B L AW89	21,05	19,05	5,0	30,0	1,91	2,4	TH2 M4x12 T15F	T15F	TH2.20	
19,05	19,05	125,0	TH2.0.750.S.D45.12.25 R/L	R AW8C L AW9A	21,05	19,05	5,0	30,0	2,41	2,9	TH2 M4x12 T15F	T15F	TH2.25	
19,05	19,05	125,0	TH2.0.750.S.D45.12.30 R/L	R AW8D L AW9B	21,05	19,05	5,0	30,0	2,91	3,8	TH2 M4x12 T15F	T15F	TH2.30	
19,05	19,05	125,0	TH2.0.750.S.D45.12.40 R/L	R AW8E L AW9C	21,05	19,05	5,0	30,0	3,81	4,9	TH2 M4x12 T15F	T15F	TH2.40	
▼ h = 20,0 mm														
20,0	20,0	125,0	TH2.2020.D45.12.15 R/L	R ASUW L ASUV	22,0	20,0	5,0	30,0	-	1,9	TH2 M4x16,6 T15F	T15F	TH2.15	AKT UPD
20,0	20,0	125,0	TH2.2020.D45.12.20 R/L	R ASUY L ASUZ	22,0	20,0	5,0	30,0	1,91	2,4	TH2 M4x16,6 T15F	T15F	TH2.20	AKT UPD
20,0	20,0	125,0	TH2.2020.D45.12.25 R/L	R ASU0 L ASUZ	22,0	20,0	5,0	30,0	2,41	2,9	TH2 M4x16,6 T15F	T15F	TH2.25	AKT UPD
20,0	20,0	125,0	TH2.2020.D45.12.30 R/L	R ASU2 L ASU1	22,0	20,0	5,0	30,0	2,91	3,8	TH2 M4x16,6 T15F	T15F	TH2.30	AKT UPD
20,0	20,0	125,0	TH2.2020.D45.12.40 R/L	R ASU4 L ASU3	22,0	20,0	5,0	30,0	3,81	4,9	TH2 M4x16,6 T15F	T15F	TH2.40	AKT UPD

Verwandte Werkzeuge finden Sie auch auf der folgenden Seite!
Related Items can be found on the following page as well!

Fortgesetzte Tabelle
Continued Table

Bestellbeispiel // Order Example: **TH2.2020.D45.12.15 R** (R = Rechte Ausführung // Right Hand Version)

Bitte stimmen Sie die technische Machbarkeit des von Ihnen gewünschten Außenfreistrichs mit unserer technischen Fachberatung ab:
+49 7473 9517-140 oder support@simtek.com
Please contact our Technical Department in order to proof the technical feasibility of the corner relief you are planning to machine:
+49 7473 9517-140 or support@simtek.com

Klemmhalter, Eckenfreistriche außen

Klemmhalter für Eckenfreistriche außen. Geeignet für Vollradiusschneidplatten sowie für passende Individualwerkzeuge.

Toolholder, External Corner Relief

Toolholder for external corner reliefs. For use with Full Radius inserts and for suitable customized tools.

Anzugsmoment (Schraube) // Tightening Torque (Screw)

4,5 Nm



TW
ST

R

Legende
Legend

203



Scan
QR-Code

Oder besuchen Sie // Or Visit
www.simtek.info/cp/1058

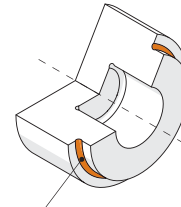
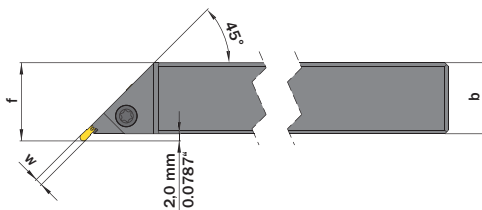
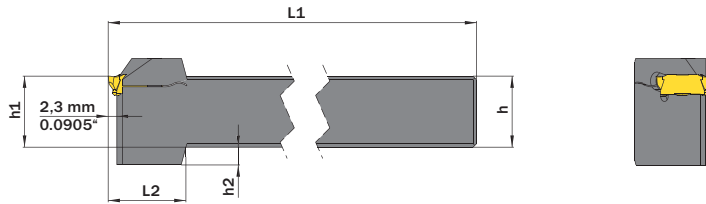

Hauptsächlich geeignet für diese Flächen
 Mainly designed for these Surfaces

Abbildung zeigt / Drawing shows: TH2.2020.D45.12.20 R

h	b	L1	Artikelnummer Part number	Webcode www.simtek.eu/webcode	f	h1 ^{is14}	h2	L2	w ≥	w ≤	Schraube Screw	Schraubenschlüssel Screw driver	Connectcode www.simtek.eu/code
mm	mm	mm			mm	mm	mm	mm	mm	mm			

Fortgesetzte Tabelle
Continued Table

Verwandte Werkzeuge finden Sie auch auf der vorhergehenden Seite!
 Related items can be found on the previous page as well!

▼ h = 25,0 mm

25,0	25,0	150,0	TH2.2525.D45.15.15 R/L	R ASU6 L ASU5	27,0	25,0	-	-	-	1,9	TH2 M4x16.6 T15F	T15F	TH2.15
25,0	25,0	150,0	TH2.2525.D45.15.20 R/L	R ASU8 L ASU7	27,0	25,0	-	-	1,91	2,4	TH2 M4x16.6 T15F	T15F	TH2.20
25,0	25,0	150,0	TH2.2525.D45.15.25 R/L	R ASVA L ASU9	27,0	25,0	-	-	2,41	2,9	TH2 M4x16.6 T15F	T15F	TH2.25
25,0	25,0	150,0	TH2.2525.D45.15.30 R/L	R ASVC L ASVB	27,0	25,0	-	-	2,91	3,8	TH2 M4x16.6 T15F	T15F	TH2.30
25,0	25,0	150,0	TH2.2525.D45.15.40 R/L	R ASVE L ASVD	27,0	25,0	-	-	3,81	4,9	TH2 M4x16.6 T15F	T15F	TH2.40

▼ h = 25,4 mm

25,4	25,4	150,0	TH2.1.000.S.D45.15.15 R/L	R AW75 L AW83	27,4	25,4	-	-	-	1,9	TH2 M4x16.6 T15F	T15F	TH2.15
25,4	25,4	150,0	TH2.1.000.S.D45.15.20 R/L	R AW76 L AW84	27,4	25,4	-	-	1,91	2,4	TH2 M4x16.6 T15F	T15F	TH2.20
25,4	25,4	150,0	TH2.1.000.S.D45.15.25 R/L	R AW77 L AW85	27,4	25,4	-	-	2,41	2,9	TH2 M4x16.6 T15F	T15F	TH2.25
25,4	25,4	150,0	TH2.1.000.S.D45.15.30 R/L	R AW78 L AW86	27,4	25,4	-	-	2,91	3,8	TH2 M4x16.6 T15F	T15F	TH2.30
25,4	25,4	150,0	TH2.1.000.S.D45.15.40 R/L	R AW79 L AW87	27,4	25,4	-	-	3,81	4,9	TH2 M4x16.6 T15F	T15F	TH2.40

Bestellbeispiel // Order Example: TH2.2525.D45.15.40 R (R = Rechte Ausführung // Right Hand Version)

Bitte stimmen Sie die technische Machbarkeit des von Ihnen gewünschten Außenfreistrichs mit unserer technischen Fachberatung ab:
 +49 7473 9517-140 oder support@simtek.com

Please contact our Technical Department in order to proof the technical feasibility of the corner relief you are planning to machine:
 +49 7473 9517-140 or support@simtek.com

Klemmhalter, Eckenfreistriche innen

Klemmhalter für Eckenfreistriche innen. Geeignet für Vollradiusschneidplatten sowie für passende Individualwerkzeuge.

Toolholder, Internal Corner Relief

Toolholder for internal corner reliefs. For use with Full Radius inserts and for suitable customized tools.

Anzugsmoment (Schraube) // Tightening Torque (Screw)

4,5 Nm



Legende
Legend **203**

Scan QR-Code Oder besuchen Sie // Or Visit
www.simtek.info/cp/480

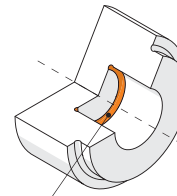
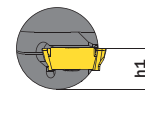
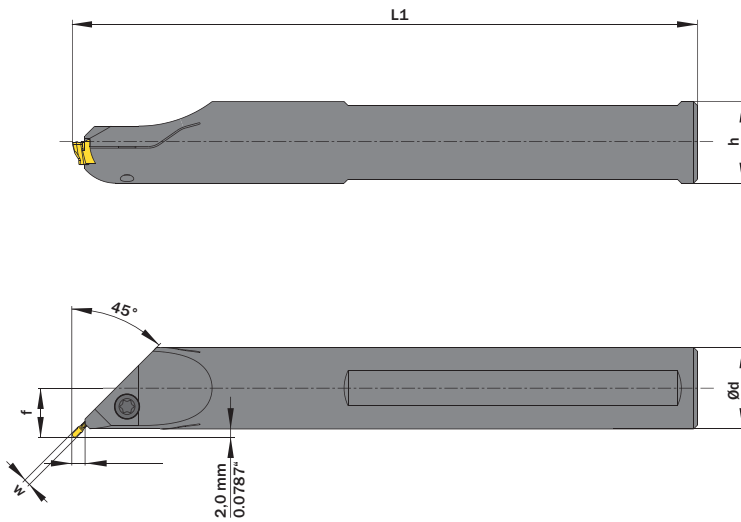

Hauptsächlich geeignet für diese Flächen
Mainly designed for these Surfaces

Abbildung zeigt / Drawing shows: TH2.0020.D45.60.18.15 R

Ød ^{g6} mm	Artikelnummer Part number	Webcode www.simtek.eu/webcode	f	h	h1	L1 ^{js14}	w ≥	w ≤	Schraube Screw	Schraubenschlüssel Screw driver	Connectcode www.simtek.eu/code
▼ Ød = 20,0 mm											
20,0	TH2.0020.D45.60.18.15 R/L	R ASV4 L ASV3	12,0	18,0	9,0	180,0	-	1,9	TH2 M4x12 T15F	T15F	TH2.15
20,0	TH2.0020.D45.60.18.20 R/L	R ASV6 L ASV5	12,0	18,0	9,0	180,0	1,91	2,4	TH2 M4x12 T15F	T15F	TH2.20
20,0	TH2.0020.D45.60.18.25 R/L	R ASV8 L ASV7	12,0	18,0	9,0	180,0	2,41	2,9	TH2 M4x12 T15F	T15F	TH2.25
20,0	TH2.0020.D45.60.18.30 R/L	R ASWA L ASV9	12,0	18,0	9,0	180,0	2,91	3,8	TH2 M4x12 T15F	T15F	TH2.30
20,0	TH2.0020.D45.60.18.40 R/L	R ASWC L ASWB	12,0	18,0	9,0	180,0	3,81	4,9	TH2 M4x12 T15F	T15F	TH2.40
▼ Ød = 32,0 mm											
32,0	TH2.0032.D45.80.25.15 R/L	R ASYY L ASYX	18,0	30,0	15,0	250,0	-	1,9	TH2 M4x12 T15F	T15F	TH2.15
32,0	TH2.0032.D45.80.25.20 R/L	R ASY0 L ASYZ	18,0	30,0	15,0	250,0	1,91	2,4	TH2 M4x12 T15F	T15F	TH2.20
32,0	TH2.0032.D45.80.25.25 R/L	R ASY2 L ASY1	18,0	30,0	15,0	250,0	2,41	2,9	TH2 M4x12 T15F	T15F	TH2.25
32,0	TH2.0032.D45.80.25.30 R/L	R ASY4 L ASY3	18,0	30,0	15,0	250,0	2,91	3,8	TH2 M4x12 T15F	T15F	TH2.30
32,0	TH2.0032.D45.80.25.40 R/L	R ASY6 L ASY5	18,0	30,0	15,0	250,0	3,81	4,9	TH2 M4x12 T15F	T15F	TH2.40

Bestellbeispiel // Order Example: TH2.0020.D45.60.18.20 R (R = Rechte Ausführung // Right Hand Version)

Bitte stimmen Sie die technische Machbarkeit des von Ihnen gewünschten Innenfreistrichs mit unserer technischen Fachberatung ab:
+49 7473 9517-140 oder support@simtek.com
Please contact our Technical Department in order to proof the technical feasibility of the corner relief you are planning to machine:
+49 7473 9517-140 or support@simtek.com

simturn® AX
simturn® DX
simturn® H2
simturn® K2
simturn® C4
simturn® GX
simturn® E3
simturn® E12
simturn® FX
simturn® Decolletage
simturn® OA
Anhang Appendix

Stechdrehen, Sicherungsringnuten

Sicherungsringnuten vgl. DIN 471/472, sowie DIN 983/984.

Grooving, Circlip Ring Grooves

Circlip Ring Grooves compare DIN 471/472, and DIN 983/984.

Schnittwerte (Start) // Cutting parameters (Start)

f (außen//ext.) 0,1 mm/U	f (innen//int.) 0,08 mm/U	Vc Seite/Page 29
------------------------------------	-------------------------------------	----------------------------

Passende Klemmhalter auf Seite // Suitable Toolholders on page

185, 186, 187, 188, 189, 190, 191, 192, 193, 194, 195, 196, 197



SP Legende
HM Legend

203

Scan QR-Code

Oder besuchen Sie // Or Visit
www.simtek.info/cp/486

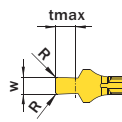
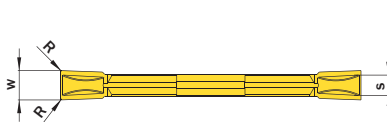
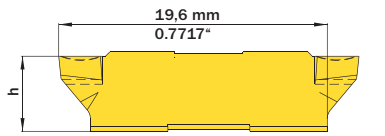

w > 1,24 mm / 0,0488" in Abhängigkeit des Klemmhalters depends on Toolholder

tmax ≤ 1,24 mm / 0,0488" 1,3 mm / 0,0512"

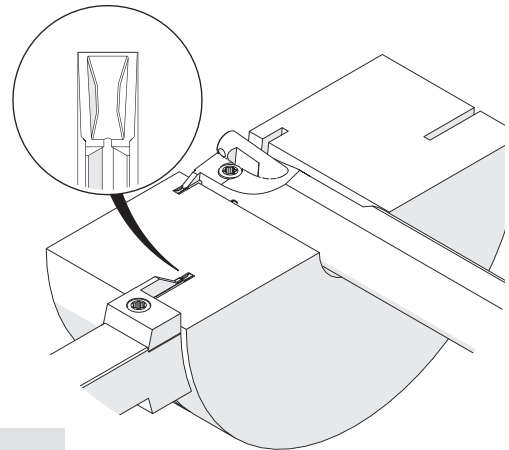

Nummernbreite Nominal width of groove	w ^{-0,05} mm	Artikelnummer Part number	Webcode www.simtek.eu/webcode	Schneidstoffgruppe Cutting Grade Group	h	R	S	Connectcode www.simtek.eu/code	
					mm	mm	mm		
1,1	1,09	TH2.110.000 GG	ASF6	G	5,5	-	1,15	TH2.15	NEU
1,3	1,44	TH2.130.000 GG	AHV2	G	5,5	-	1,15	TH2.15	NEU
1,6	1,74	TH2.160.010 GG	AWMF	G	5,5	0,1	1,15	TH2.15	AKT
1,85	1,99	TH2.185.010 GG	AWMG	G	5,5	0,1	1,6	TH2.20	AKT
2,15	2,29	TH2.215.015 GG	AWMH	G	5,5	0,15	1,6	TH2.20	
2,65	2,79	TH2.265.015 GG	AWMJ	G	5,5	0,15	2,1	TH2.25	
3,15	3,29	TH2.315.015 GG	AWMK	G	5,5	0,15	2,65	TH2.30	
4,15	4,29	TH2.415.015 GG	AWMM	G	5,5	0,15	3,5	TH2.30	

Bestellbeispiel // Order Example: **TH2.130.000 GG GN39** (GN39 = Schneidstoff // Grade)



TH2. w, 1/100 mm, 3 Stellen/Digits R, 1/100 mm, 3 Stellen/Digits Toleranz // Tolerance G

Beispielartikelnummer // Example Part number: **TH2.156.015 XGG**

Einstecken und Profildrehen

CNC-Konturdrehen.

Grooving and Profiling

CNC Profiling.

Schnittwerte (Start) // Cutting parameters (Start)

f (außen//ext.) 0,1 mm/U	f (innen//int.) 0,08 mm/U	Vc Seite/Page 29
------------------------------------	-------------------------------------	----------------------------

Passende Klemmhalter auf Seite // Suitable Toolholders on page

**185, 186, 187, 188, 189, 190, 191, 192, 193,
194, 195, 196, 197**



SP Legende
HM Legend

203



Scan
QR-Code

Oder besuchen Sie // Or Visit
www.simtek.info/cp/483



Abbildung zeigt / Drawing shows: TH2.400.020 NG

$w^{+0,03}$ mm	R mm	Artikelnummer Part number	Webcode www.simtek.eu/webcode	Schneidstoffgruppe Cutting Grade Group	h mm	s mm	Connectcode www.simtek.eu/code
▼ R = 0,05 mm							
1,5	0,05	TH2.150.005 NG	AF26	G	5,5	1,15	TH2.15
2,0	0,05	TH2.200.005 NG	AHEM	G	5,5	1,6	TH2.20
2,5	0,05	TH2.250.005 NG	AKG3	G	5,5	2,1	TH2.25
3,0	0,05	TH2.300.005 NG	ACFA	G	5,5	2,65	TH2.30
▼ R = 0,2 mm							
1,5	0,2	TH2.150.020 NG	ADSK	G	5,5	1,15	TH2.15
2,0	0,2	TH2.200.020 NG	AEHZ	G	5,5	1,6	TH2.20
2,5	0,2	TH2.250.020 NG	APQW	G	5,5	2,1	TH2.25
3,0	0,2	TH2.300.020 NG	AFZM	G	5,5	2,65	TH2.30
3,5	0,2	TH2.350.020 NG	ASY7	G	5,5	2,65	TH2.30
4,0	0,2	TH2.400.020 NG	AKDM	G	5,5	3,5	TH2.40
▼ R = 0,4 mm							
3,0	0,4	TH2.300.040 NG	AGVW	G	5,5	2,65	TH2.30
3,5	0,4	TH2.350.040 NG	ASY8	G	5,5	2,65	TH2.30
4,0	0,4	TH2.400.040 NG	ABAZ	G	5,5	3,5	TH2.40

Bestellbeispiel // Order Example: **TH2.200.020 NG GN39** (GN39 = Schneidstoff // Grade)

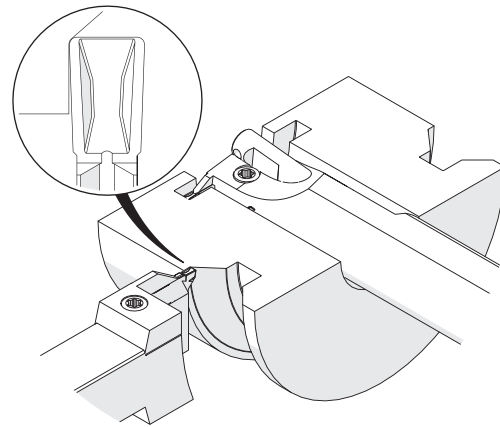
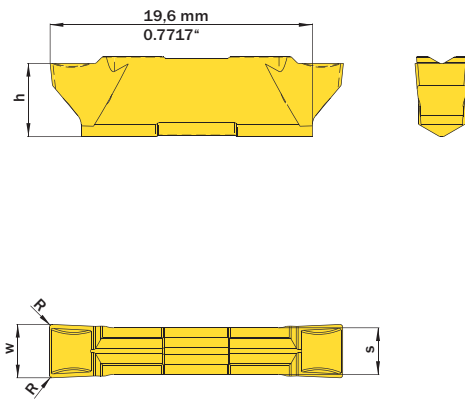

TH2. **w, 1/100 mm, 3 Stellen/Digits** . **R, 1/100 mm, 3 Stellen/Digits** | Toleranz // Tolerance G
Beispielartikelnummer // Example Part number: **TH2.156.015 XGG**

simturn® AX
simturn® DX
simturn® H2
simturn® K2
simturn® C4
simturn® GX
simturn® E3
simturn® E12
simturn® FX
simturn® Decolletage
simturn® OA
Anhang Appendix

Einstecken und Profildrehen, Vollradius

Vollradiusnuten, CNC-Konturdrehen.

Grooving and Profiling, Full Radius

Full Radius, CNC Profiling.

Schnittwerte (Start) // Cutting parameters (Start)

f (außen//ext.) 0,05 mm/U	f (innen//int.) 0,04 mm/U	Vc Seite/Page 29
-------------------------------------	-------------------------------------	----------------------------

Passende Klemmhalter auf Seite // Suitable Toolholders on page

185, 186, 187, 188, 189, 190, 191, 192, 193, 194, 195, 196, 197



SP Legende
HM Legend
203

Scan QR-Code Oder besuchen Sie // Or Visit
www.simtek.info/cp/485

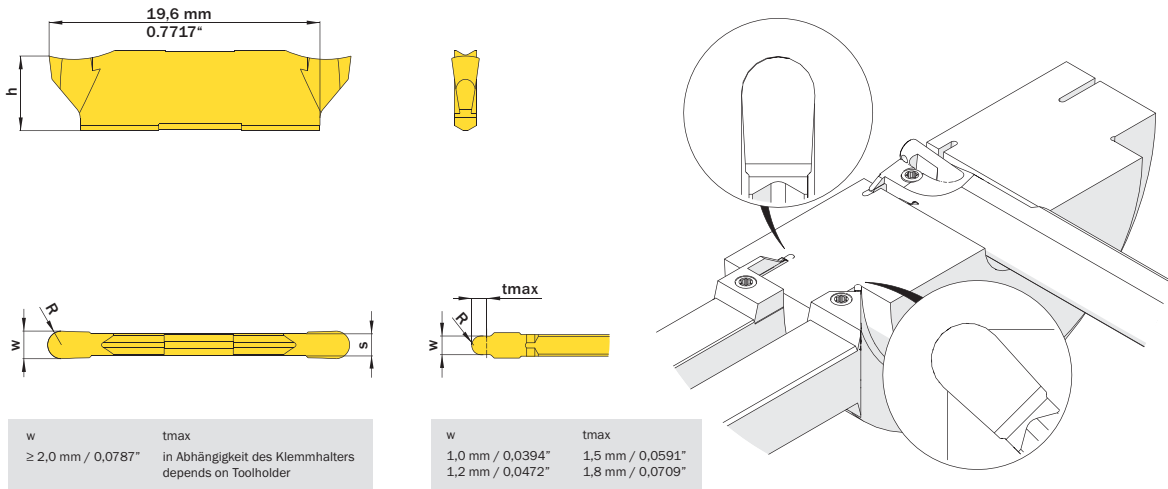

w	tmax
≥ 2,0 mm / 0,0787"	in Abhängigkeit des Klemmhalters depends on Toolholder

w	tmax
1,0 mm / 0,0394"	1,5 mm / 0,0591"
1,2 mm / 0,0472"	1,8 mm / 0,0709"

w ^{-0,05}	R	Artikelnummer Part number	Webcode www.simtek.eu/webcode	Schneidstoffgruppe Cutting Grade Group	h	s	Connectcode www.simtek.eu/code
mm	mm				mm	mm	
1,0	0,5	TH2.100.050 VS	ASZF	G	5,4	1,15	TH2.15
1,2	0,6	TH2.120.060 VS	ASZE	G	5,4	1,15	TH2.15
2,0	1,0	TH2.200.100 VS	ASZD	G	5,4	1,6	TH2.20
2,5	1,25	TH2.250.125 VS	ASZC	G	5,4	2,1	TH2.25
3,0	1,5	TH2.300.150 VS	ASZB	G	5,4	2,65	TH2.30
4,0	2,0	TH2.400.200 VS	ASZA	G	5,4	3,5	TH2.40
5,0	2,5	TH2.500.250 VS	ASY9	G	5,4	3,5	TH2.40

Bestellbeispiel // Order Example: **TH2.100.050 VS GN39** (GN39 = Schneidstoff // Grade)

Abstechen

Verfügbar in verschiedenen Winkeln und Breiten.

Parting Off

Available in different angles and widths.

Schnittwerte (Start) // Cutting parameters (Start)

f (außen//ext.) 0,1 mm/U	f (innen//int.) 0,08 mm/U	Vc Seite/Page 29
------------------------------------	-------------------------------------	----------------------------

Passende Klemmhalter auf Seite // Suitable Toolholders on page

**185, 186, 187, 188, 189, 190, 191, 192, 193,
194, 195, 196, 197**

SP

Legende

HM

Legende

203

Scan QR-Code

Oder besuchen Sie // Or Visit www.simtek.info/cp/735



Abbildung zeigt / Drawing shows: TH2.R200.12 PG

$w_{-0,05}$ mm	R mm	K	Artikelnummer Part number	Webcode www.simtek.eu/webcode	Schneidstoffgruppe Cutting Grade Group	h mm	s mm	Connectcode www.simtek.eu/code
▼ w = 2,0 mm								
2,0	0,1	6°	TH2.R200.06 PG	ATPG	G	5,5	1,6	TH2.20
2,0	0,1	12°	TH2.R200.12 PG	ATPJ	G	5,5	1,6	TH2.20
▼ w = 2,5 mm								
2,5	0,1	6°	TH2.R250.06 PG	ATPM	G	5,5	2,1	TH2.25
2,5	0,1	12°	TH2.R250.12 PG	ATPP	G	5,5	2,1	TH2.25
▼ w = 3,0 mm								
3,0	0,1	6°	TH2.R300.06 PG	ATPS	G	5,5	2,64	TH2.30
3,0	0,1	12°	TH2.R300.12 PG	ATPU	G	5,5	2,64	TH2.30

Bestellbeispiel // Order Example: **TH2.R200.06 PG GN39** (GN39 = Schneidstoff // Grade)

simturn® AX
simturn® DX
simturn® H2
simturn® K2
simturn® C4
simturn® GX
simturn® E3
simturn® E12
simturn® FX
simturn® Decolletage
simturn® OA

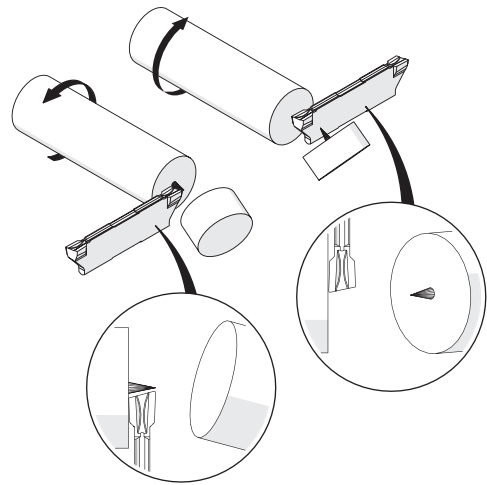
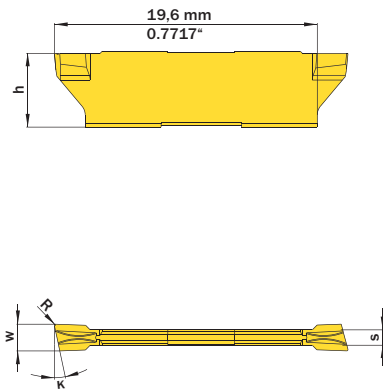
Anhang
Appendix

Abstechen

Verfügbar in verschiedenen Winkeln und Breiten.

Parting Off

Available in different angles and widths.

Schnittwerte (Start) // Cutting parameters (Start)

f (außen//ext.) 0,1 mm/U	f (innen//int.) 0,08 mm/U	Vc Seite/Page 29
------------------------------------	-------------------------------------	----------------------------

Passende Klemmhalter auf Seite // Suitable Toolholders on page

185, 186, 187, 188, 189, 190, 191, 192, 193, 194, 195, 196, 197



SP Legende
HM Legend

203

Scan
 QR-Code

Oder besuchen Sie // Or Visit
www.simtek.info/cp/725



Abbildung zeigt / Drawing shows: TH2.L200.12 PG

$w^{-0,05}$ mm	R mm	K	Artikelnummer Part number	Webcode www.simtek.eu/webcode	Schneidstoffgruppe Cutting Grade Group	h mm	s mm	Connectcode www.simtek.eu/code
▼ w = 2,0 mm								
2,0	0,1	6°	TH2.L200.06 PG	ATPH	G	5,5	1,6	TH2.20
2,0	0,1	12°	TH2.L200.12 PG	ATPK	G	5,5	1,6	TH2.20
▼ w = 2,5 mm								
2,5	0,1	6°	TH2.L250.06 PG	ATPN	G	5,5	2,1	TH2.25
2,5	0,1	12°	TH2.L250.12 PG	ATPQ	G	5,5	2,1	TH2.25
▼ w = 3,0 mm								
3,0	0,1	6°	TH2.L300.06 PG	ATPT	G	5,5	2,64	TH2.30
3,0	0,1	12°	TH2.L300.12 PG	ATPV	G	5,5	2,64	TH2.30

Bestellbeispiel // Order Example: **TH2.L200.06 PG GT45** (GT45 = Schneidstoff // Grade)

Info

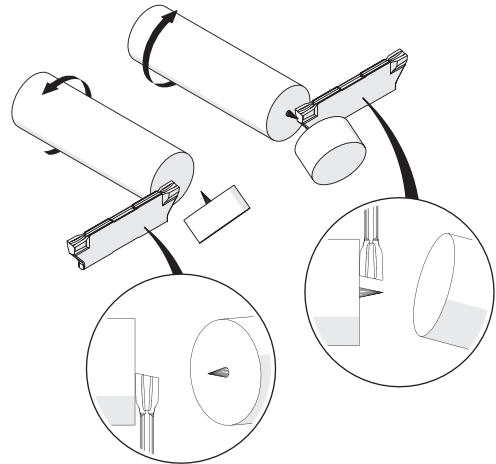
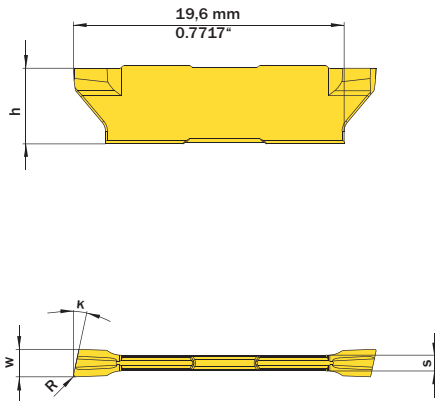
Legende Legend



Schneidwerkzeug aus Hartmetall // Carbide Insert // Outils coupants en carbure de tungstène // Inserto in metallo duro



Trägerwerkzeug aus Stahl // Steel Toolholder // Porte-outils en acier // Porta inserto in acciaio



Rechts wie gezeichnet // Right hand version shown, left hand version inversely // A droite comme présenté // In figura utensile destro



Innere Kühlmittelzufuhr // Trough coolant // Refroidissement interne // Lubrificazione interna

Index

simturn® H2 Produktverzeichnis simturn® H2 Product list

Artikelnr. // Part Nr.	S/P
TH2.265.015 GG	198
TH2.300.005 NG	199
TH2.300.020 NG	199
TH2.300.040 NG	199
TH2.300.150 VS	200
TH2.315.015 GG	198
TH2.350.020 NG	199
TH2.350.040 NG	199
TH2.400.020 NG	199
TH2.400.040 NG	199
TH2.400.200 VS	200
TH2.415.015 GG	198
TH2.500.250 VS	200
TH2.L200.06 PG	202
TH2.L200.12 PG	202
TH2.L250.06 PG	202
TH2.L250.12 PG	202
TH2.L300.06 PG	202
TH2.L300.12 PG	202
TH2.R200.06 PG	201
TH2.R200.12 PG	201
TH2.R250.06 PG	201
TH2.R250.12 PG	201
TH2.R300.06 PG	201
TH2.R300.12 PG	201

simturn® AX

simturn® DX

simturn® H2

simturn® K2

simturn® C4

simturn® GX

simturn® E3

simturn® E12

simturn® FX

simturn®
Decolletage

simturn® OA

Anhang
Appendix

205